

How to Self Report Doses in the Patient Connect App

Q. My participant has already taken their dose without using the Patient Connect app. How can they use the app to report this?

A. The participant can follow the steps below to submit a Self-Reported dose:

1. Open the Patient Connect app on their device
2. If they are still within the dosing window for that day, they can tap on the “Medication Already Taken” button located below the large **START** button
3. Confirm that they’ve already taken their medication for the current window.
4. Input the time the dose was taken
5. Then tap **CONFIRM** to save the self-report

If they have a stable internet connection at the time of self-reporting, the dose will update to reflect being self-reported for that window on the dashboard.

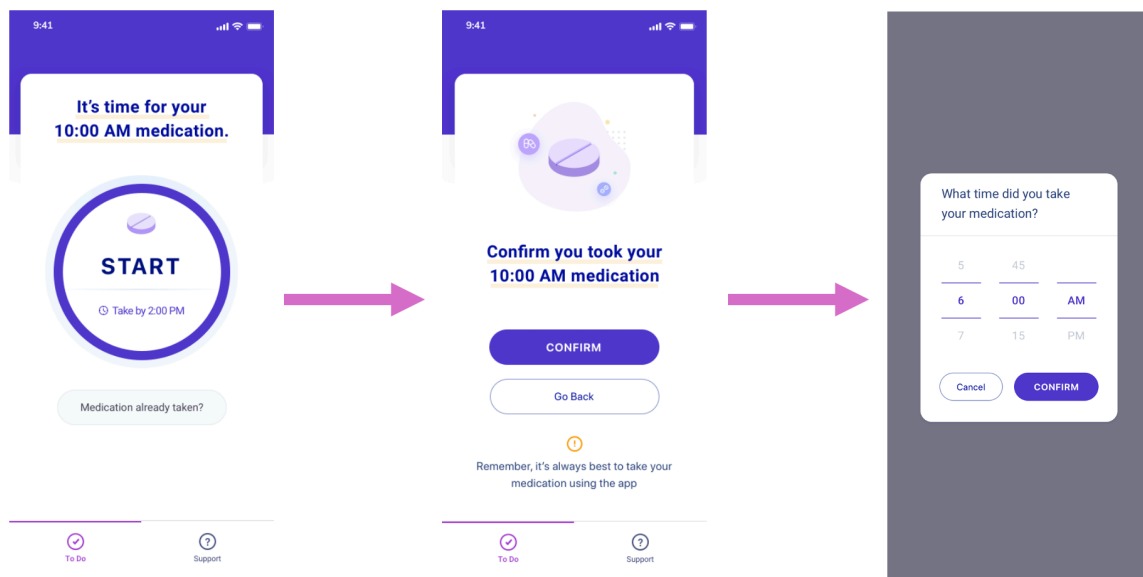

Q. My participant is outside of the window they want to self-report their dose for. How can it be reported as being taken?

A. For safety, the app will not permit participants to self-report doses if the participant is outside of the window (i.e. the window to dose was 8:00 AM – 2:00 PM and they are trying to use the app at 3:00 PM to report the dose). The dose should appear on the dashboard as **MISSED**, at which

point the site coordinator can reclassify it from there. Please refer to our article entitled [How to Reclassify Doses](#) if needed.

Q. My participant accidentally self-reported their dose incorrectly. How can this be corrected?

A. As a safety precaution, the app is programmed not to allow the participant to modify their dose for the remainder of the window after a self-report is logged. However, the participant can communicate this with their site and can dose without the app. The site coordinator can then receive approval from their sponsor to reclassify the Self-Reported dose on the dashboard to Site-Reported at the correct time.